

Malibu Collection
WHITE SHAKER

WALL CABINETS

Solid Wood

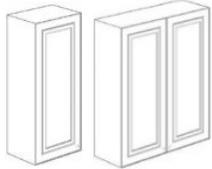

30" HEIGHT

| | |
|------|--------|
| W09" | 133.82 |
| W12" | 150.95 |
| W15" | 172.82 |
| W18" | 185.51 |
| W21" | 202.33 |
| W24" | 226.52 |
| W27" | 240.41 |
| W30" | 255.65 |
| W33" | 266.19 |
| W36" | 280.77 |

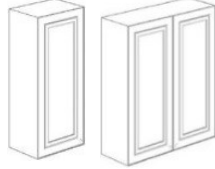

36" HEIGHT

| | |
|------|--------|
| W09" | 153.63 |
| W12" | 175.12 |
| W15" | 189.41 |
| W18" | 203.58 |
| W21" | 235.53 |
| W24" | 254.06 |
| W27" | 266.62 |
| W30" | 281.99 |
| W33" | 296.29 |
| W36" | 308.72 |

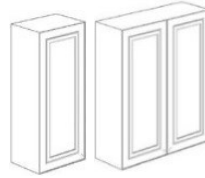

42" HEIGHT

| | |
|------|--------|
| W09" | 174.97 |
| W12" | 190.47 |
| W15" | 207.17 |
| W18" | 219.48 |
| W21" | 260.67 |
| W24" | 276.77 |
| W27" | 292.30 |
| W30" | 303.78 |
| W33" | 319.95 |
| W36" | 336.65 |

Innocraft
 ECO CABINETRY
 friendly

Door: Solid Wood (Rubberwood)
Frame: Solid Wood (Rubberwood)
 (Doors are made in one piece solid wood)
Frame: Flush face frame, Full Overlay
Panel: 5/8" Plywood
Tracks: Undermount Soft close
Hinges: Soft close
Drawer: Solid wood Dovetailed
Interior: Natural Wood Color
Vanities: All Standard Sizes Available

BASE CABINETS

Solid Wood



DOORS

| | |
|------|--------|
| B09" | 195.33 |
| B12" | 210.72 |
| B15" | 230.77 |
| B18" | 249.87 |
| B21" | 267.66 |
| B24" | 311.08 |
| B27" | 339.54 |
| B30" | 367.99 |
| B33" | 399.89 |
| B36" | 421.74 |

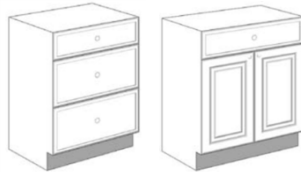

DRAWERS & SINK

| | |
|--------------|--------|
| DB15" | 363.43 |
| DB18" | 394.20 |
| DB21" | 436.05 |
| DB24" | 461.09 |
| DB30" | 503.53 |
| Sink30" | 286.50 |
| Sink33" | 300.65 |
| Sink36" | 317.96 |
| Sink42" | 335.52 |
| SinkDiag 41" | 317.46 |

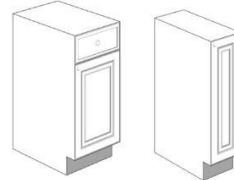

UTILITY

| | |
|-------------|--------|
| Spice 6" | 280.69 |
| Spice 9" | 305.22 |
| Trash15"S | 356.67 |
| Trash18"D | 249.87 |
| BLS 33" | 385.40 |
| BLS 36" | 500.58 |
| Blind 42" | 537.71 |
| End Diag12" | 338.14 |
| Ovb24" | 267.52 |
| Ovb30" | 283.56 |

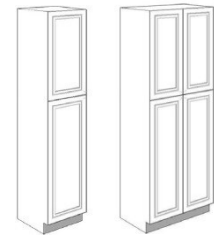

WALL PANTRY

| | |
|---------|--------|
| WP1884" | 631.83 |
| WP1890" | 660.49 |
| WP1896" | 681.07 |
| WP2484" | 767.54 |
| WP2490" | 790.64 |
| WP2496" | 819.54 |
| WP3084 | 854.41 |
| WP3090" | 883.29 |
| WP3096" | 909.07 |

Above The Appliance

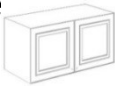

(Width) (Height) (Depth)

| | |
|---------|--------|
| W242424 | 256.13 |
| W301212 | 160.80 |
| W301512 | 171.88 |
| W302112 | 194.04 |
| W302412 | 213.57 |
| W301524 | 257.59 |
| W301812 | 182.96 |
| W301224 | 243.83 |
| W301824 | 271.36 |
| W302124 | 281.90 |
| W302424 | 291.78 |
| W361212 | 172.95 |
| W361512 | 185.23 |
| W361812 | 197.51 |
| W362112 | 211.13 |
| W362412 | 234.14 |
| W361224 | 234.77 |
| W361524 | 249.20 |
| W361824 | 263.63 |
| W362124 | 279.39 |
| W362424 | 313.13 |

Wine Rack



WC3018 305.03

Microwave Cabinet



| | |
|---------|--------|
| MWC2730 | 296.60 |
| MWC2736 | 334.03 |
| MWC2742 | 371.45 |

Wall End Diagonal



| | |
|-------|--------|
| WED30 | 259.29 |
| WED36 | 284.83 |
| WED42 | 306.21 |

Wall Corner Diagonal



| | |
|---------|--------|
| WDC2430 | 293.93 |
| WDC2436 | 312.05 |
| WDC2442 | 343.55 |

Accessories

Moldings

| | |
|--------------------------|-------|
| Crown Molding 1 5/8 | 75.95 |
| Crown Molding 2 3/4 | 91.26 |
| Flat Crown Molding 1 5/8 | 66.13 |
| Flat Crown Molding 2 3/4 | 82.48 |
| Bottom Molding 3/4 | 52.49 |
| Scribe Molding 8ft | 16.52 |
| Corner Molding 8ft | 33.84 |

Fillers

| | |
|---------------|-------|
| Filler 3 x 30 | 21.67 |
| Filler 3 x 36 | 24.04 |
| Filler 3 x 42 | 26.41 |
| Filler 3 x 96 | 59.02 |
| Filler 6 x 96 | 82.99 |

Support Panels

| | |
|--------------------------|--------|
| Refrigerator 24 x 96 x 1 | 153.70 |
| Refrigerator 34 x 96 x 1 | 199.81 |
| Dishwasher 24 x 35 x 1 | 67.14 |

Skin Panels

| | |
|-----------------------|--------|
| Finish Panel 12 x 96 | 60.48 |
| Island Panel 35 x 96 | 134.27 |
| Island Panel 48 x 96 | 176.86 |
| Base Panel 35 x 22 | 28.73 |
| Pantry Panel 24 x 96 | 62.90 |
| Wall Panel 12 x 30 | 13.76 |
| Wall Panel 12 x 36 | 16.70 |
| Wall Panel 12 x 42 | 19.65 |
| Wall Bottom 12 x 96 | 35.05 |
| Toe Kick 8ft 4.5 x 96 | 25.85 |

VANITIES

Depth: 21" Height: 32"

| | |
|-----------------|--------|
| Drawer Base 15 | 351.62 |
| Drawer Base 18 | 373.57 |
| Sink Base 24 | 232.11 |
| Sink Base 30 | 256.61 |
| Vanity w/DB 30* | 391.13 |
| Vanity w/DB 36* | 459.52 |
| Vanity w/DB 42 | 603.17 |
| Vanity w/DB 48 | 662.18 |
| Vanity w/DB 60 | 741.82 |



VDB15

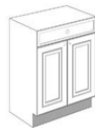

SB24



VA30L/R



VA42



VA60



VDB18



SB30



VA36 L/R



VA48

*Drawer Base to the left or right of sink can be specified

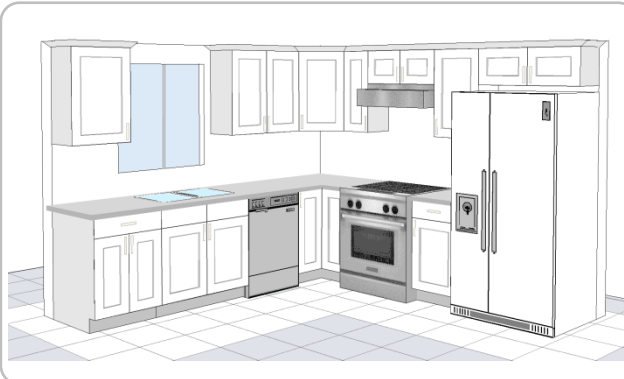

AVERAGE KITCHEN ESTIMATE

| 10 X 10 Kitchen | | COLORS | PRICE |
|-----------------|---------|-----------------|---------|
| B18 | W1236 | White Shaker | \$3,155 |
| B21 | W1836 | Grey Shaker | \$3,155 |
| SB36 | W2136 | Ash Taupe | \$3,121 |
| BLS36 | W3336 | Antique White | \$3,708 |
| TK8x2 | W3018 | American Walnut | \$4,602 |
| BPF34x2 | W3618 | | |
| WPF36x5 | WDC2436 | | |